

Optical Society of San Diego

Thursday Evening - February 19, 2004

Optics Educational Outreach in San Diego at the



The Science Center closes to the public at 5 pm, we will be in the

William & Grayson Boehm Community Forum

Guest Speakers:

Aly Evans, Director of Educational Programs, Fleet Science Center

Donn Silberman, Director, Optics Institute of Southern California

The evening's events will start with: (5:30 pm)

- Hands-On Optics Demonstrations & Exhibits
- Socializing with Optics Experts
- Free program & buffet for local educators (OSSD will buy you dinner!!)



Presentations will begin with: (7:30 pm)

- Aly Evans - Optics Exhibits & Outreach at the Fleet Science Center
- Donn Silberman – The OISC – Organizing & Implementing Optics Ed.
 - The Optics Suitcase, OPTRICKS & The National Effort

**Take home Optics Tools you can use and
lots of ideas for your classrooms!!**

Please contact the meeting host, Donn Silberman of Optics Institute of Southern California at donn@oisc.net (preferred), or by phone at 949-636-6170 by February 13, (Friday) with the name of each attendee, phone number, email, and company affiliation. Dinner for OSSD members is the usual \$15.

Fleet Science Center - Phone: 619.238.1233

Directions to Fleet Science Center and our room are on their website

<http://www.rhfleet.org/site/visit/directions.html>

<http://www.rhfleet.org/site/visit/maps.html>

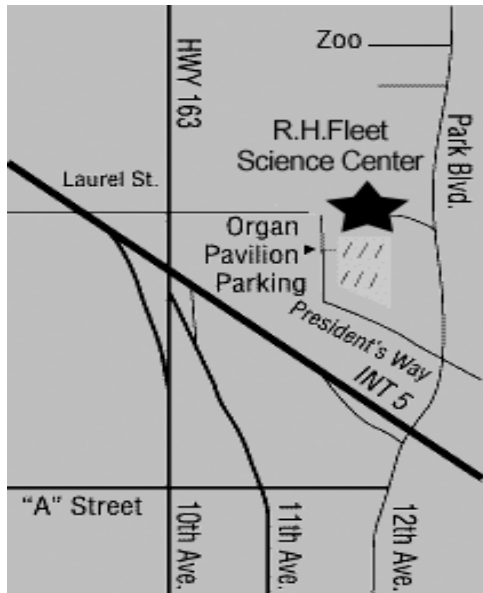

OSSD Meeting will be here. Enter the room directly from the outside; do not go to the main entrance.

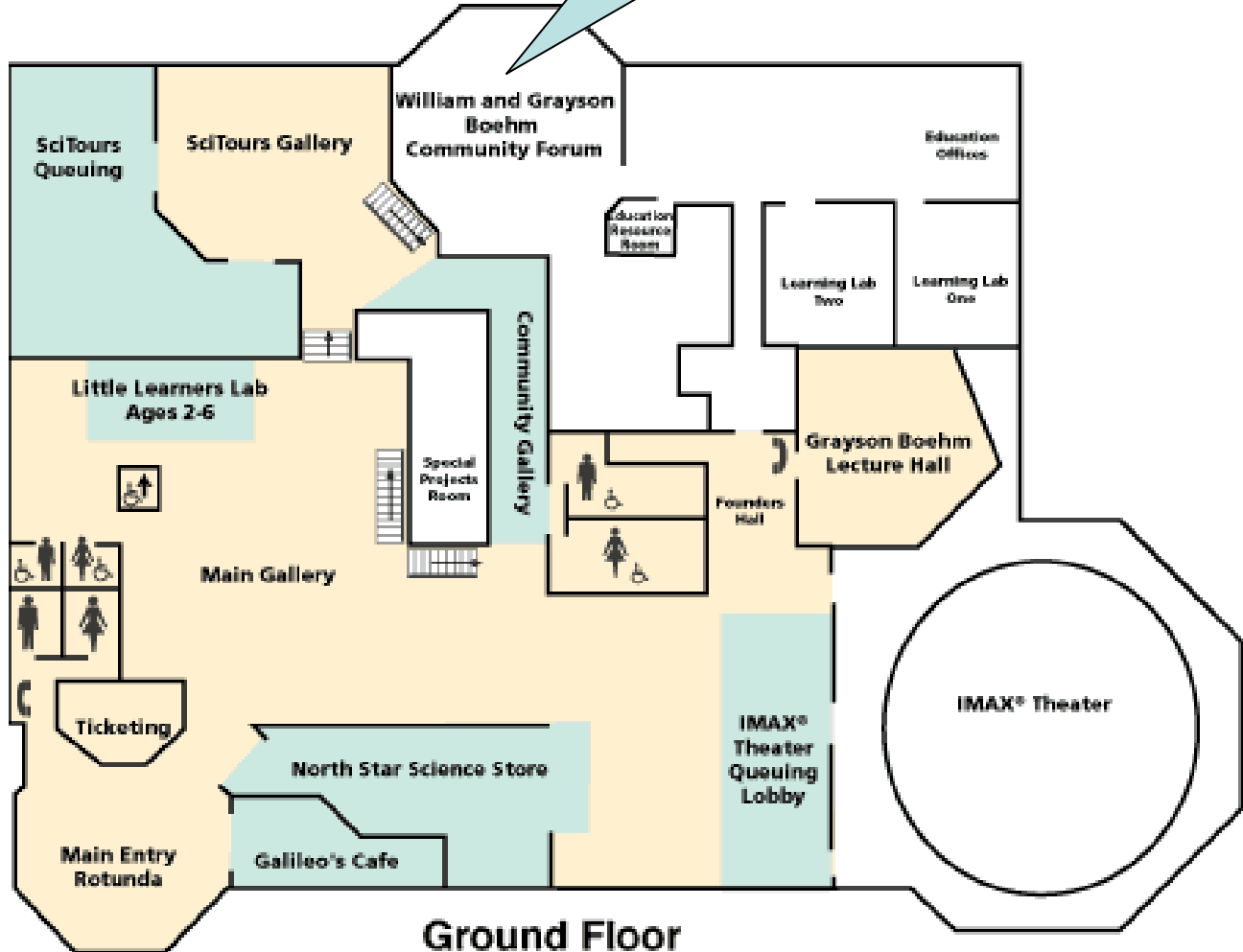

Ground Floor

Directions to the Fleet Science Center

- **Directions From Interstate 5 south:**

Take 10th Ave. exit near downtown. Turn left on A street at the first light. While turning get into one of the 2 right lanes, cross 11th Ave., then turn left on 12th Ave. which becomes Park Blvd. Go through 4 lights and then make a left turn at Space Theater Way into our parking lot.

Directions from Interstate 5 north:

Take the Pershing Drive - B Street exit. Turn left on B Street then right at the first light on 12th Ave., which becomes Park Blvd. Go through 4 lights and then make a left turn at Space Theater Way into our parking lot.

Directions from Interstate 8:

From Interstate 8 take Highway 163 south in Mission Valley. Take the Park Blvd exit from 163. Turn left on Park Blvd. Go through 2 lights and then make a left turn at Space Theater Way into our parking lot.

Directions from Interstate 805:

From Interstate 805 take Interstate 8 west to Highway 163. Take highway 163 south and exit at Park Blvd. Turn left on Park Blvd. Go through 2 lights and then make a left turn at Space Theater Way into our parking lot.

Directions from Highway 163 south:

Take the Park Blvd. exit and turn left on Park Blvd. Go through two lights and then make a left turn at Space Theater Way into our parking lot.

Directions from San Diego Airport:

Take Harbor Drive downtown to Grape Street and turn left. Take Interstate 5 South to 10th Ave. exit. Turn left onto A St. then left on 12th Ave., which turns into Park Blvd. Go through three lights and then make a left turn at Space Theater Way into our

Call for Judges
by Kelly Cummings
OSSD Science Fair Coordinator

**The 50th Annual
Greater San Diego Science and Engineering Fair**

<http://www.gsdsef.org>

March 24-28, 2004

Balboa Park Activity Center

Judging: Wednesday, March 24, 2004

11:30 AM to 2:30 PM

The OSSD will again be participating at the San Diego Science and Engineering Fair. Every year we assemble a panel of judges to review the student's projects, looking for outstanding optical and photonic related subjects. Awards are given to both the Senior and Junior Division winners and also to the second place finishers. In addition, we award a Melles Griot HeNe Laser to the teacher/advisor of both the Senior and Junior Division First Place Winners.

If you would like to volunteer as a Science Fair Judge, please contact the Science Fair Coordinator, Kelly Cummings, at kcummings@ossd.org. Judging will be on Wednesday, March 24, 2004 from 11:30 AM to 2:30 PM at the Balboa Park Activity Center.

Later in the Meeting Year, we will host an Educator Outreach Meeting for teachers and science educators. At this meeting we will also host the winning students with each of their projects for display. As usual, the meeting is open to the public, and we will be treating any attending science teacher (with a teacher ID) to a free pizza dinner! OSSD members: bring your local middle school and high school science teachers!